

Data sheet - Support roller STO 10TN X (cylindrical, with inner ring)

Designation	STO 10 X
Type	cylindrical
D [mm]	30
d [mm]	10
F, Fw * [mm max.]	14
B1 [mm]	12
B [mm]	11,8
d1 [mm]	20
r [mm]	0,3
Dynamic load Crw [N]	8400
Static load C0rw [N]	9200
Speed limit [min-1]	11000

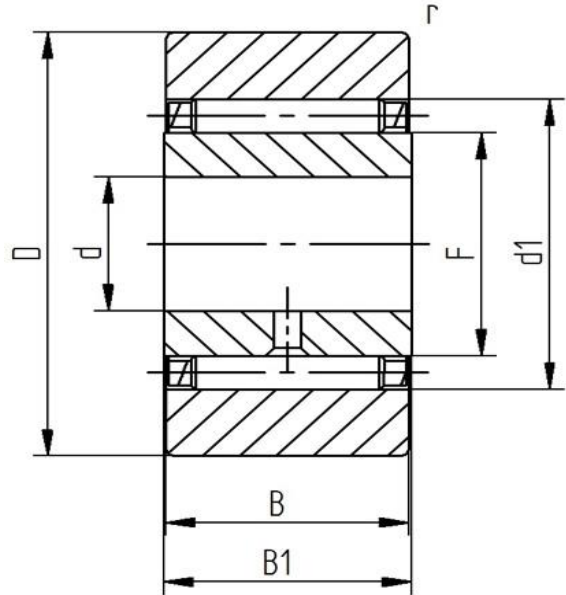

Every specification has been edited and verified carefully. STI Bearings GmbH assumes no liability for potential errors or incompleteness. Technical modifications are subject of changes.
 © 2020 by STI Bearings GmbH
 Reproduction, even excerpts, only with our approval.